

## The Wedderburn: Plot 242 (See Site Plan for location)

On the ground floor, this period style family home has an entrance vestibule, a fully fitted dining kitchen; lounge with patio door to a private garden, storage cupboard; under-stair storage; WC and utility room.

The first floor has 3 large bedroom. The master bedroom has a spacious en-suite. Two further large bedrooms, with built-in wardrobes, and bright characterful family bathroom; storage.

The home has gas central heating.



Are you interested in this development? Enquire now.

T: 01721 540488

E: [mail@hudsonhirsell.com](mailto:mail@hudsonhirsell.com)

W: [hudsonhirsell.com](http://hudsonhirsell.com)

- Kitchen/Dining Room
- Ample storage
- WC downstairs
- Lounge with patio windows to garden
- 3 Bedrooms
- Master bedroom with En-suite
- Private garden
- Allocated off street parking

Hudson Hirsell LLP give notice that this plan is for illustrative purposes only and does not form part of any contract or constitute any representation or warranty. Any information shown is given in good faith but should not be relied on by the purchaser as a statement of fact. Any areas, measurements (including room sizes) are approximate and may vary. The text, plans and images are for guidance only and not necessarily comprehensive. These images were prepared from preliminary plans and specifications prior to completion of the design and the properties and intended as a guide only. Hudson Hirsell LLP reserves the right to amend the specification as necessary without prior notice.

## The Wedderburn: Plot 242

### Ground Floor

Vestible:	2.10 x 1.45m
Lounge:	3.50 x 5.90m
Utility:	1.80 x 1.70m
WC:	1.40 x 3.10m
Kitchen/Dining:	3.30 x 5.90m



### First Floor

Bedroom 1:	3.50 x 4.10m
En-suite:	2.30 x 1.70m
Bedroom 2:	3.30 x 2.90m
Bedroom 3:	3.30 x 2.90m
Bathroom:	2.60 x 1.70m

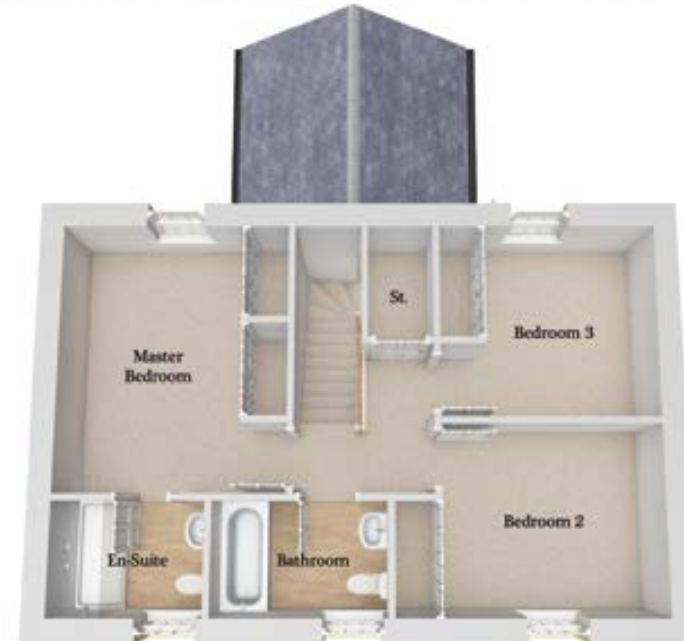

Accommodation of approximately  
118sq ms or 1265 sq ft.